

**Note: Specifications are subject to change without notice. Always consult factory.**

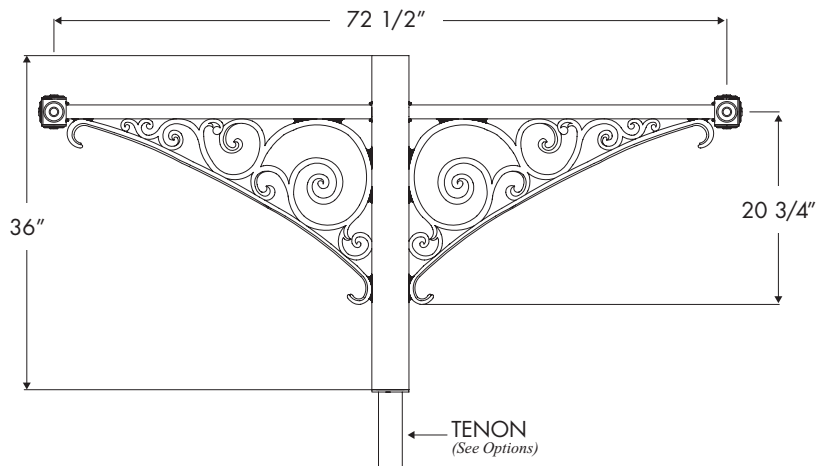

**CR-13B**

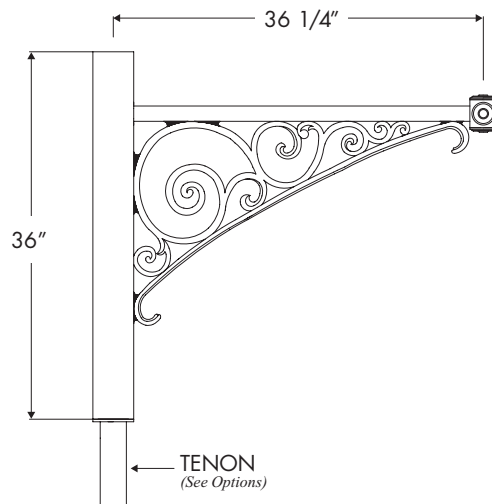

**CR-13A**

*Durable Cast and Extruded Aluminum Construction*

## CONFIGURATIONS

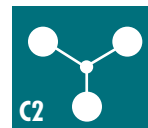

### Options

Cross Arm tenon is fitted for 3" and 4" diameter poles per request.

### Environmental Lighting for Architecture, Inc.

17891 Arenth Avenue, City of Industry, CA 91748-1197  
626.965.0821 • 800.423.6561 • fax 626.965.9494  
[www.ela-lighting.com](http://www.ela-lighting.com)