



Project Name:
Type:

Environmental Lighting for Architecture, Inc.

## Industrial - IND LED Ordering Matrix

# Industrial

ELA's Industrial family of fixtures is a modern operating fixture with a style inspired by America's Industrial Revolution. This combination gives the Industrial a look that fits both small scale architectural projects as well as large municipality needs. The Industrial body is constructed from high quality aluminum ensuring longevity and strength. Also offered is the substitution of the teardrop glass for a flat glass lens to adhere to the growing demand for full cut-off compliance.



Fixture is "Buy America Act" Compliant Proudly Made in the U.S.A.



Project Name:
Type:

# Industrial - IND

## LED Ordering Matrix

Environmental Lighting for Architecture, Inc.

1	2	3	4	5	6	7	8	9
IND								

**1. Fixture:** Matrix #: IND Description: Industrial Fixture

**2. Size:** Matrix #: 50 Weight: 40 lbs. EPA: 1.7  
60 Weight: 57 lbs. EPA: 2.6

**3. Mounting:** Matrix #: CR\* Description: Cross Arm  
BR\* Description: Wall Bracket  
CP Description: Chain Pendant  
SP Description: Stem Pendant

\*Specify which Cross Arm or Wall Bracket is to be used. See ELA website for choices.

**4. Distribution:** Matrix #: H2 Type 2 - Horizontal  
H3 Type 3 - Horizontal  
H4 Type 4 - Horizontal  
H5 Type 5 - Horizontal  
Horizontal  
V3 Type 3 - Vertical  
V5 Type 5 - Vertical  
Vertical

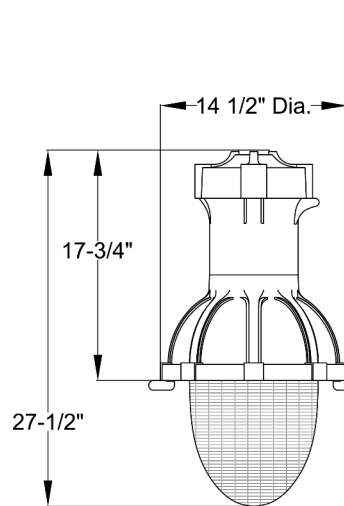

**IND/50**  
Horizontal Max: 69W

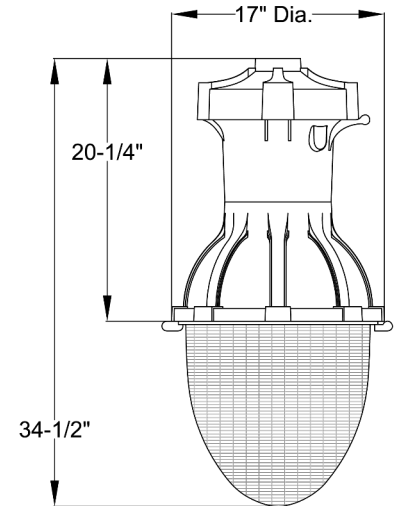

**IND/60**  
Horizontal Max: 135W

5. Lamping:	Matrix #:	Description:	Diodes	Lumens*	Wattage*	Efficacy	LED Drive (mA)	Standard Dimming Type**
	35LED	LED Board	24	3360	35	96	292	1-10VDC, Triac, Forward Phase
	50LED	LED Board	56	4800	50	96	417	1-10VDC, Triac, Forward Phase
	69LED	LED Board	56	6624	69	96	575	1-10VDC, Triac, Forward Phase
	101LED*	LED Board	100	9696	101	96	842	1-10VDC, Triac, Forward Phase
	135LED*	LED Board	100	12960	135	96	1125	1-10VDC, Triac, Forward Phase

1) Other wattages & lumens available upon request.

2) Other dimming types available upon request.

\* Size 60 ONLY

6. Color Temps (k):	Matrix #:	Description:
	AM*	Amber Color Temp
	27	2700k Color Temp
	30	3000k Color Temp
	40	4000k Color Temp
	50	5000k Color Temp

Note: Other color temperatures & RGB's available upon request.

\*Amber not available in corn cobs.

7. Voltage:	Matrix #:	Description:
	120	120VAC
	208	208VAC
	240	240VAC
	277	277VAC
	347*	347VAC
	480*	480VAC

\*Contact ELA for details.

8. Lens:	Matrix #:	Description:
	TG	Teardrop Glass
	CG*	Clear Horizontal Tempered Flat Glass
	FG*	Frosted Horizontal Tempered Flat Glass

\*Full Cut-Off Compliant.

9. Finish:	Matrix #:	Description:
(Standard Powder Coat)	AG	Augustine Green
	CC	Charcoal
	DB	Dark Bronze
	GY	Architectural Grey
	MG	Malaga Green
	MN	Black - Midnight
	PW	Pewter
	SB	Statuary Bronze
	VL	Village Green
	WH	White

Note: Custom colors available upon request.

10. Options:	Matrix #:	Description:
	PCB	Photocell Button
	TB	Terminal Block
	PCR3*	3 Pin Photo Control Receptacle
	PCR5*	5 Pin Photo Control Receptacle
	PCF7*	7 Pin Photo Control Receptacle
	HSS	House Side Shield

1. BBU LED lumen output reduced in BBU mode.

2. ELA Can integrate client specified Wifi /remote control components upon request.

\* See ELA for mounting options.

### ELA Warranty Info:

Environmental Lighting for Architecture, Inc. (ELA) offers a Five (5) Year Warranty on all products exclusively manufactured by ELA. Furthermore, ELA offers a Five (5) Year Warranty on all LED and LED components; and guarantees that no fewer than 90% of the diodes in each fixture will still be operating during this time. Please contact ELA for the details of each warranty.